

PORTFOLIO

DMITRII SHCHERBAKOV

Often look back at the asses in order to avoid future mistakes
noble.
Prutkov

Siberian federal university
Institute of architecture and design
Department of architectural design
Speciality "Architecture"

PORTFOLIO

DMITRII SHCHERBAKOV



DMITRII SHCHERBAKOV

15 1990
1997- 2007 104
1999- 2006 2
2007
2009
2011
3dsMAX : AutoCAD, Corel Draw, Photoshop, SketchUP,
E- mail: 91m@mail.ru : +79233777135

Was born on March 15th, 1990, in Zheleznogorsk of Krasnoyarsk territory

Education:

1997-2007 General High School No. 104, Podgorny, Krasnoyarsk territory

1999-2006 Art school No.2, Podgorny, Krasnoyarsk territory

In 2007 entered Siberian Federal University, Institute of Architecture and Design, the faculty of architecture Major: architect

Competitions:

2009, participation in the competition for design engineering of mountain climber cottage, which is located on Raduzhnoye lake in Nature Park Ergaki. This project was accomplished under the guidance of architect A.D. Myakota. The project took the lead.

In 2011 took part in the competition for reconstruction and restoration of the left-bank riverwalk of Krasnoyarsk. This project was accomplished under the guidance of O.Ph. Smirnova.

Professional skills:

Experienced user of the following programs: AutoCAD, Corel Draw, Photoshop, Sketch Up, 3DsMAX

Contacts:

Tel.: +79233777135
E- mail: 91m@mail.ru



CONTENTS

.....8
.....14
.....20
.....29
.....30
.....32
.....34

Academic disciplines
Drawing.....8
Painting.....14
Design disciplines
Volume designing.....20
Interior design.....29
Urban development.....30
Reconstruction.....32
Diploma designing.....34

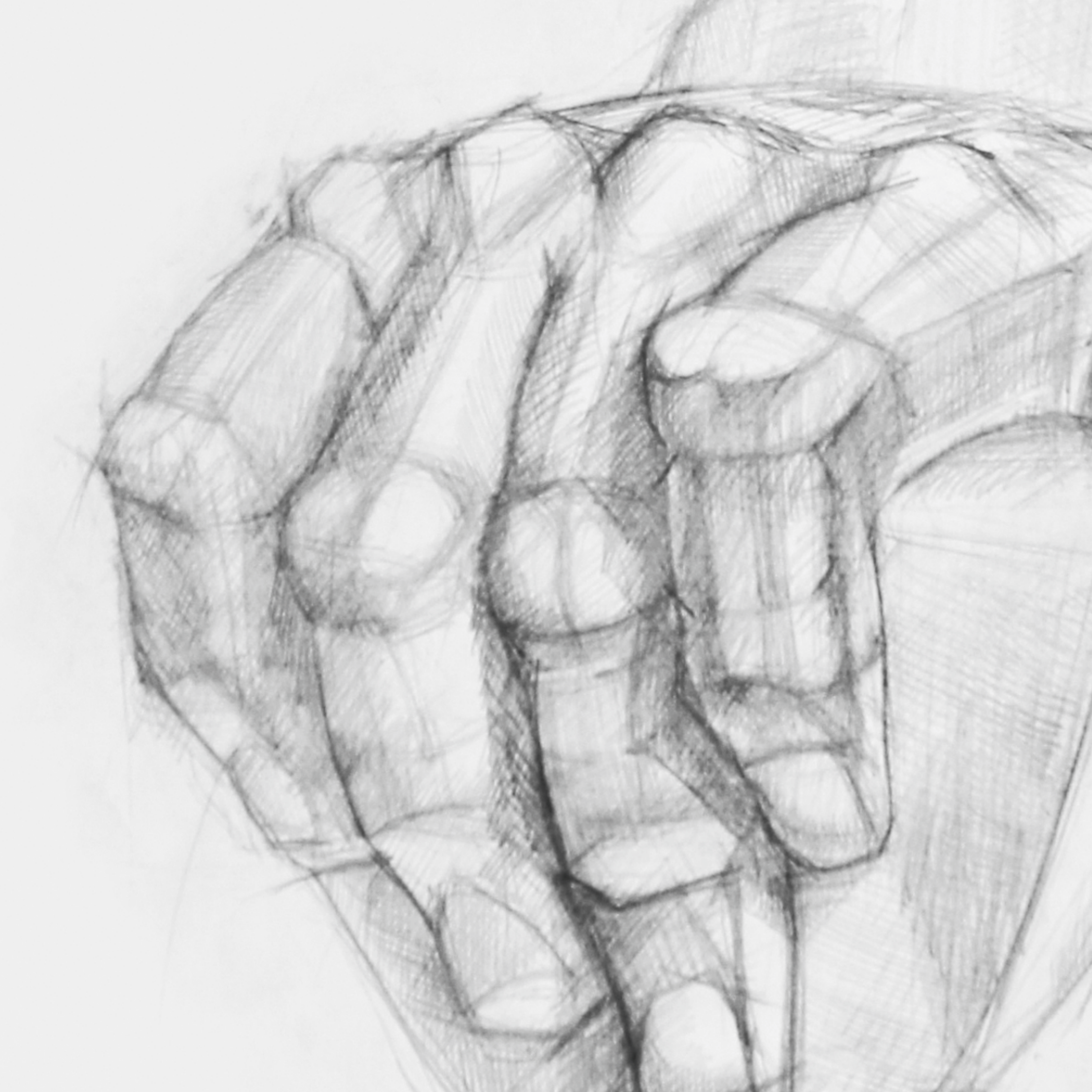

ACADEMIC DISCIPLINES

DRAWING

Department "Drawing, painting and sculpture"

Teachers:

Musat B- professor
Nikitina M- associate professor
Ganzov M- head lecture
Cheredova E- head lecture
Abaev Y- associate professor

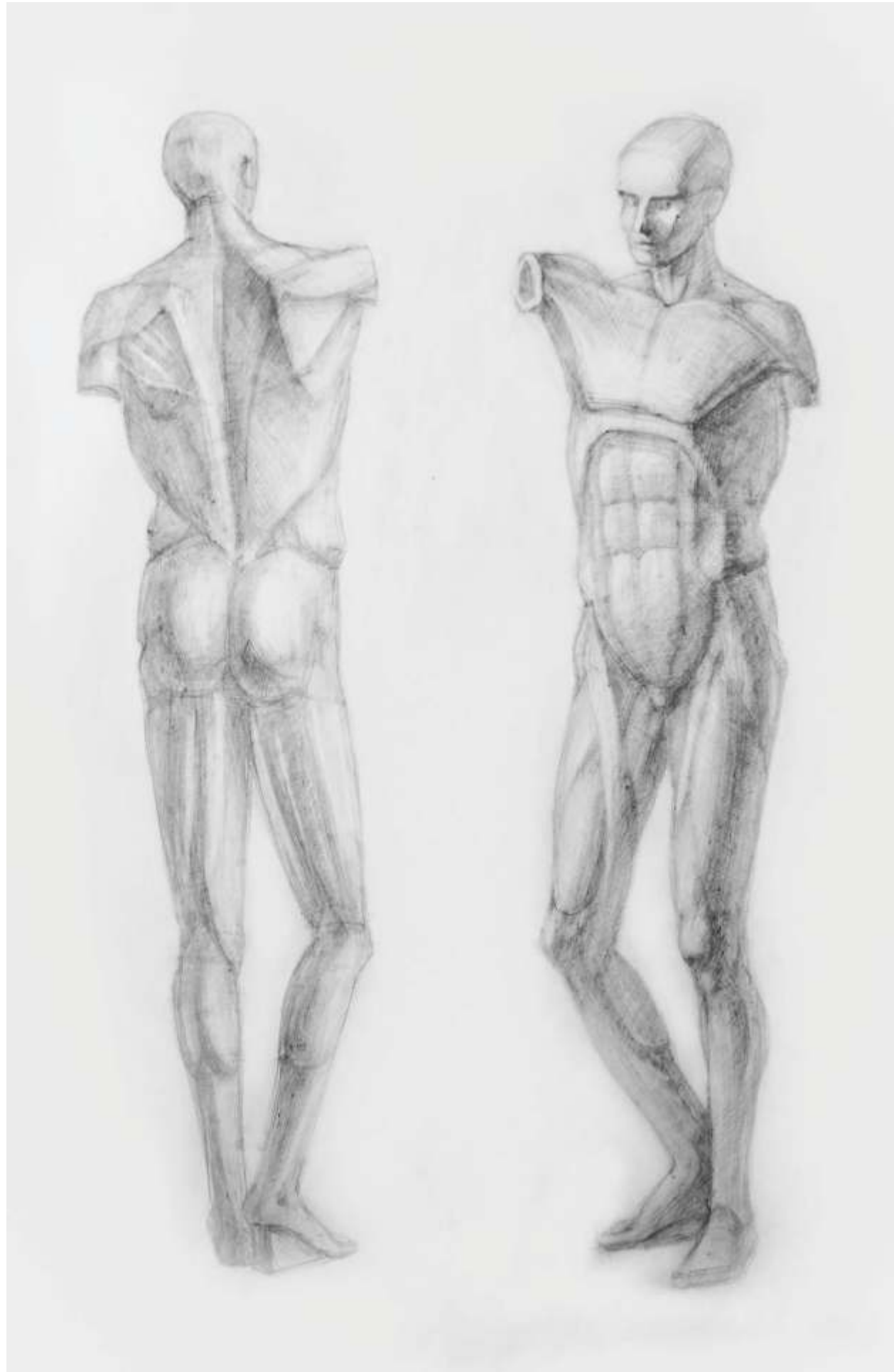

Ecorse
Pencil, paper

Teachers:
Musat B,
Nikitana M

Apollo
Pencil, paper

Teachers:
Musat B,
Nikitana M





Body parts, hands
Pencil, paper

Teachers:
Musat B,
Nikitana M



Body parts, hands
Pencil, paper

Teachers:
Musat B,
Nikitana M

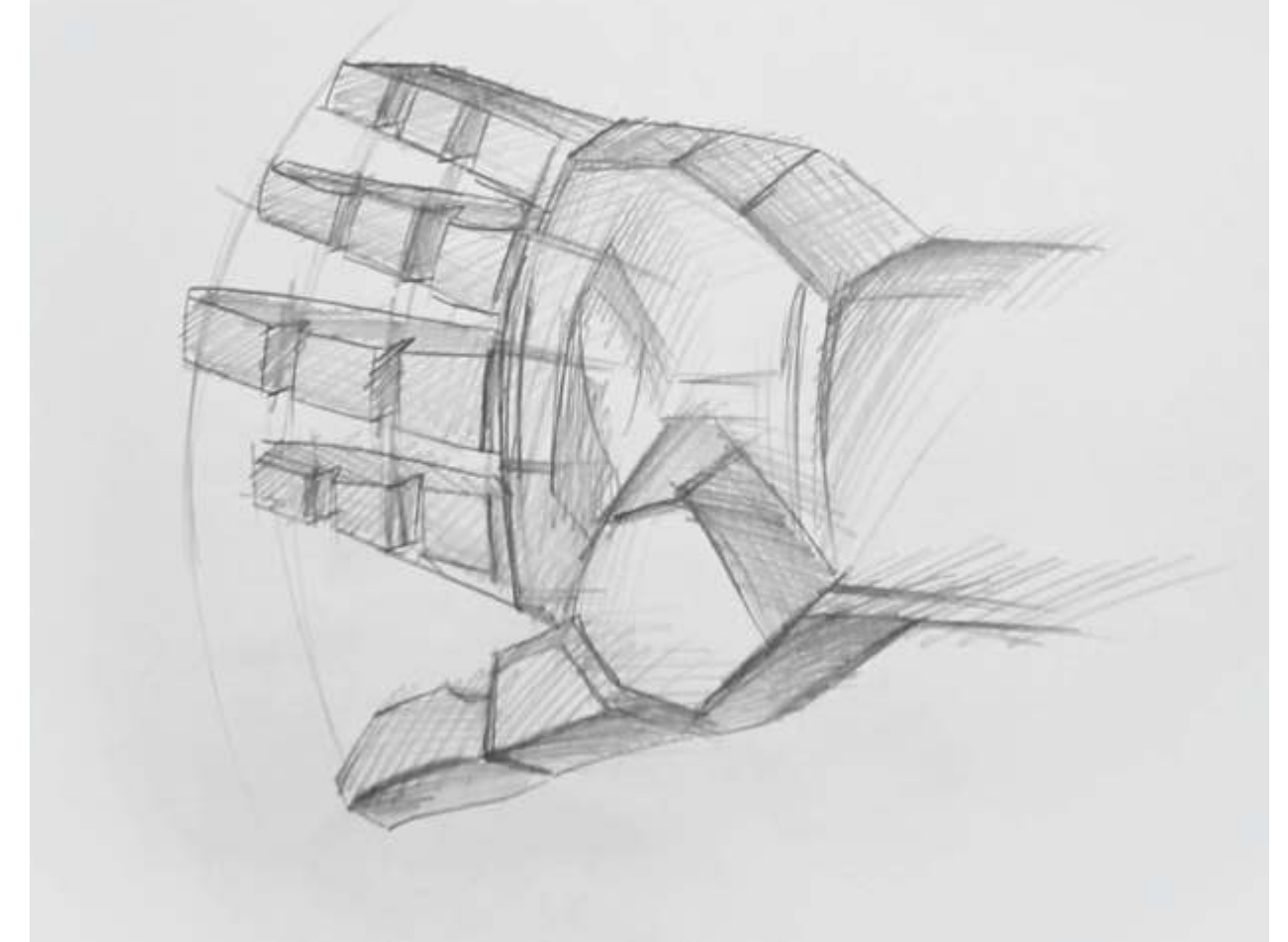

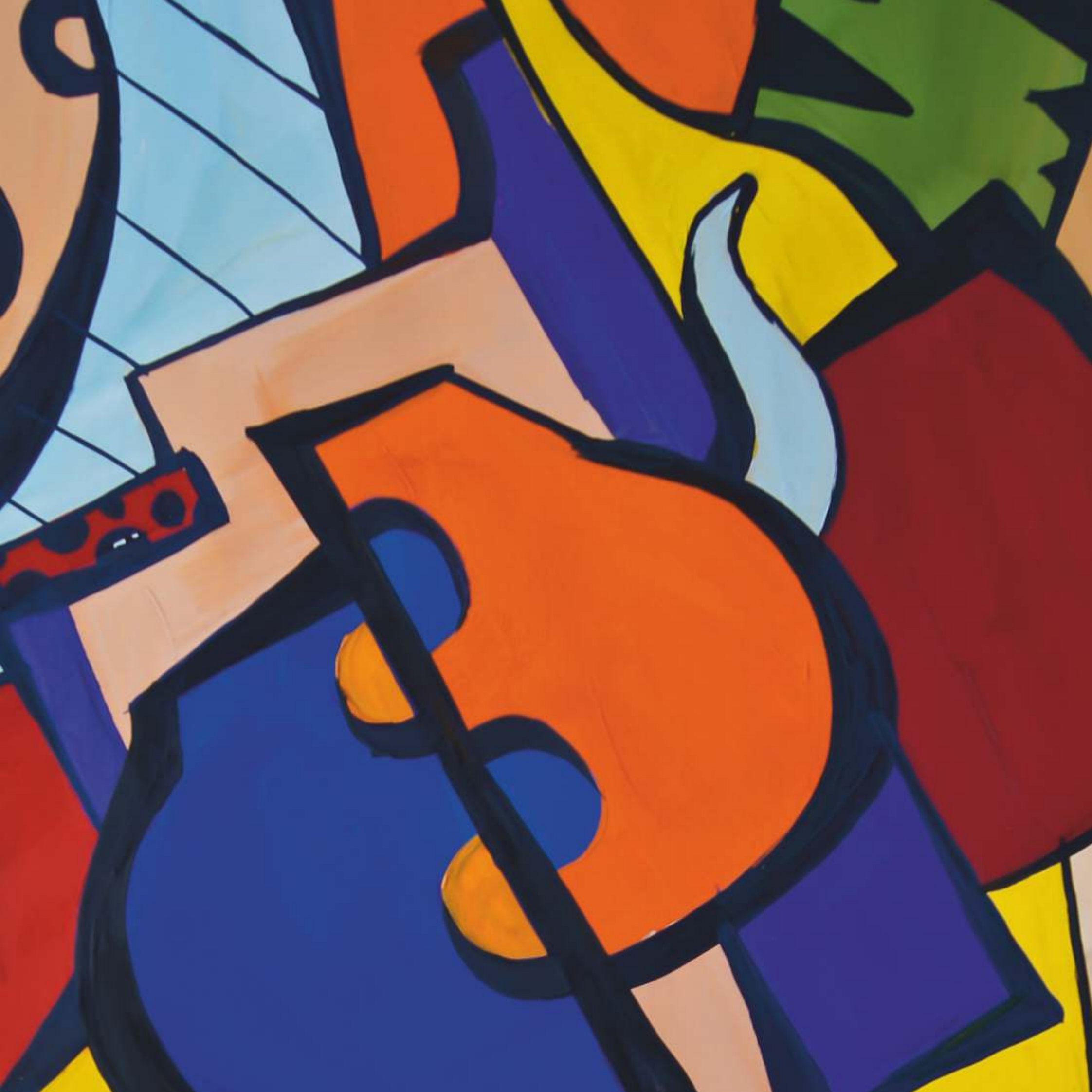

ACADEMIC DISCIPLINES

PAINING

“Drawing, painting and sculpture”
: -
- -
- -

Department “Drawing, painting and sculpture”

Teachers:

Karepov G- professor
Yakovlev V- associate professor
Murina N- associate professor
Nikitina M- associate professor
Serdyuk O- head lecture



Still life
Gouache, paper

Teachers:
Murina N,
Yakovlev V



Still life
Gouache, paper

Teachers:
Murina N,
Yakovlev V



Still life, Cubism
Gouache, paper

Teachers:
Murina N,
Nikitina M



Still life, Cubism
Gouache, paper

Teachers:
Murina N,
Nikitina M



DESIGN DISCIPLINES

VOLUME DESIGNING

Department "Architectural design"

Teachers:

- Batalova N - the assistant professor
- Blyankinstein O - the assistant professor
- Greekov N - assistant professor
- Panov E - professor
- Blinnikov B - assistant professor
- Matnina T - assistant professor
- Kiselev - head lecturer
- Yamaletdinov S - assistant professor
- Dyadichkin H - assistant



"Chapel of St. Paraskeva"

Teachers:
Batalova N

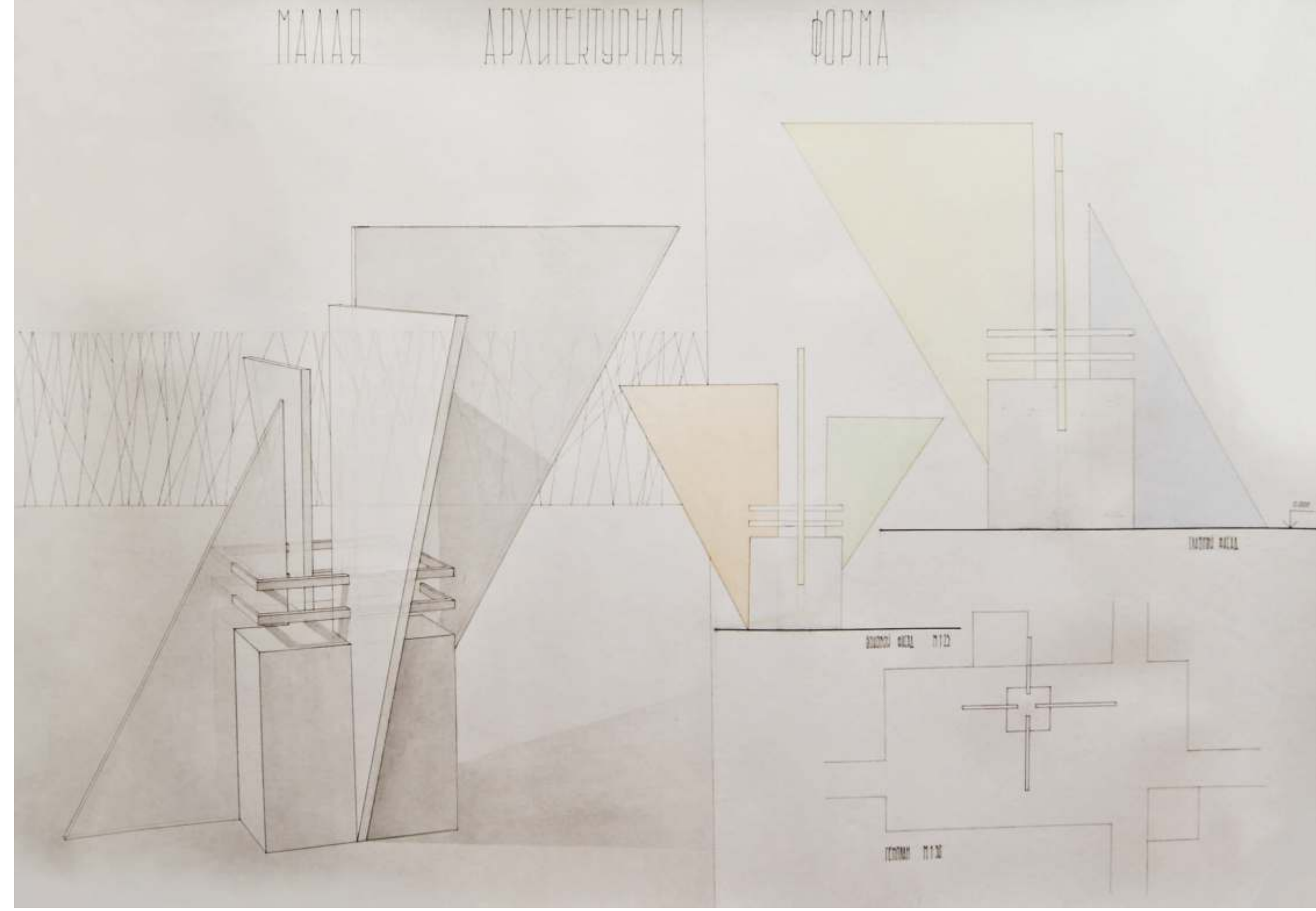

"Small architectural form"

Teachers:
Batalova N



Club

Teachers:
Batalova N
Grekov N

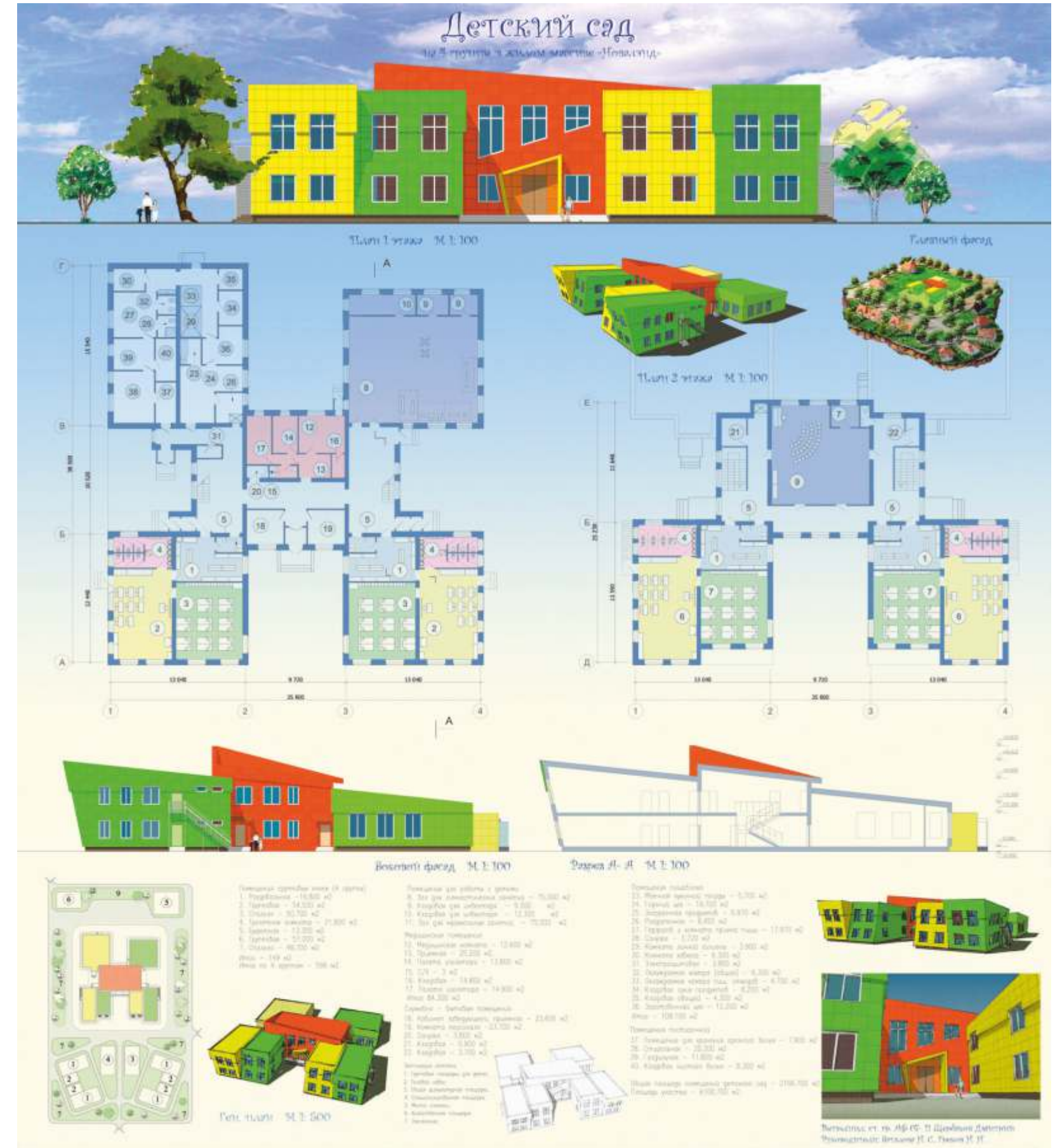

Kindergarten

Teachers:
Batalova N
Grekov N

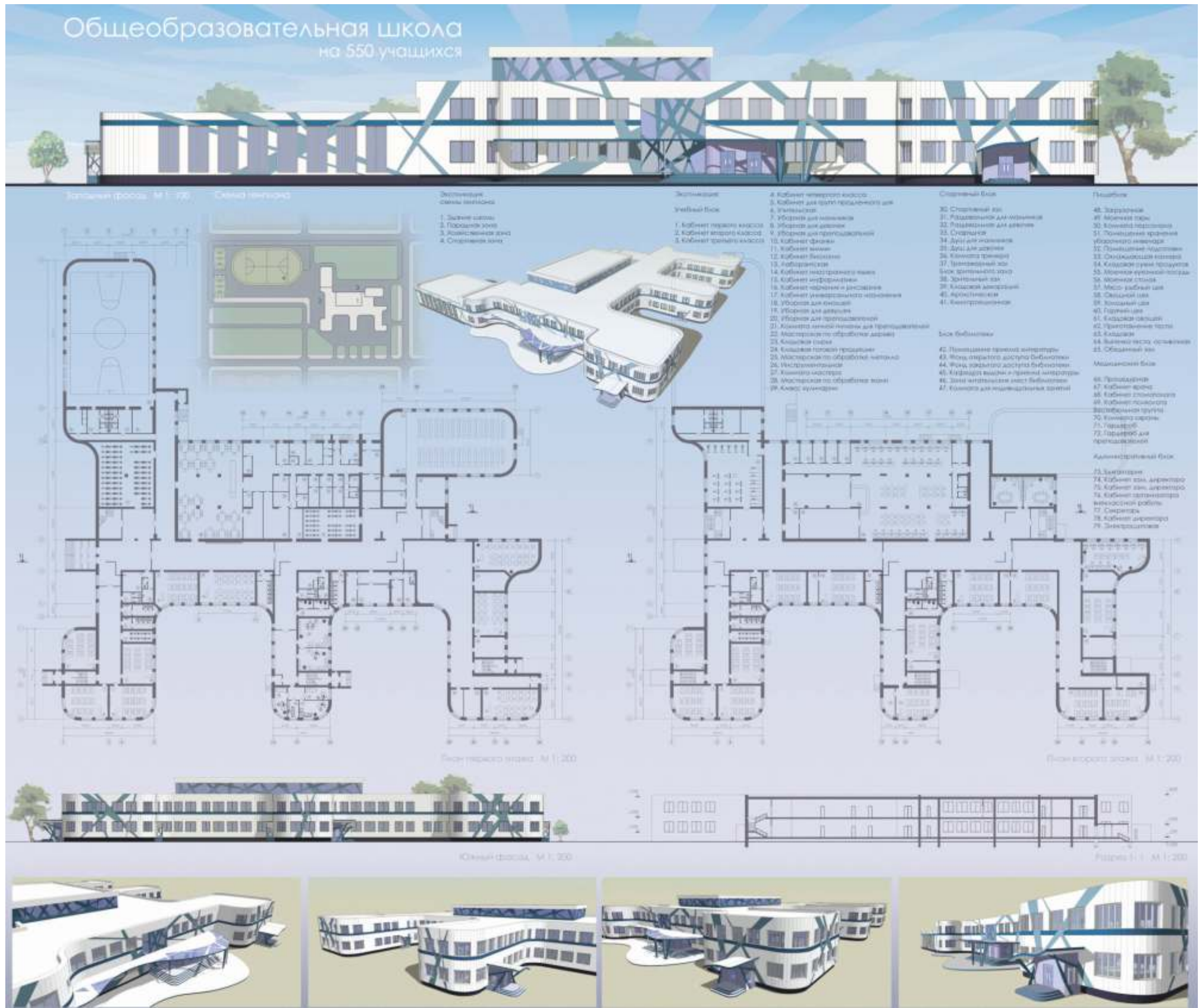

Secondary school

Teachers:
Yamaletdinov S
Grekov N

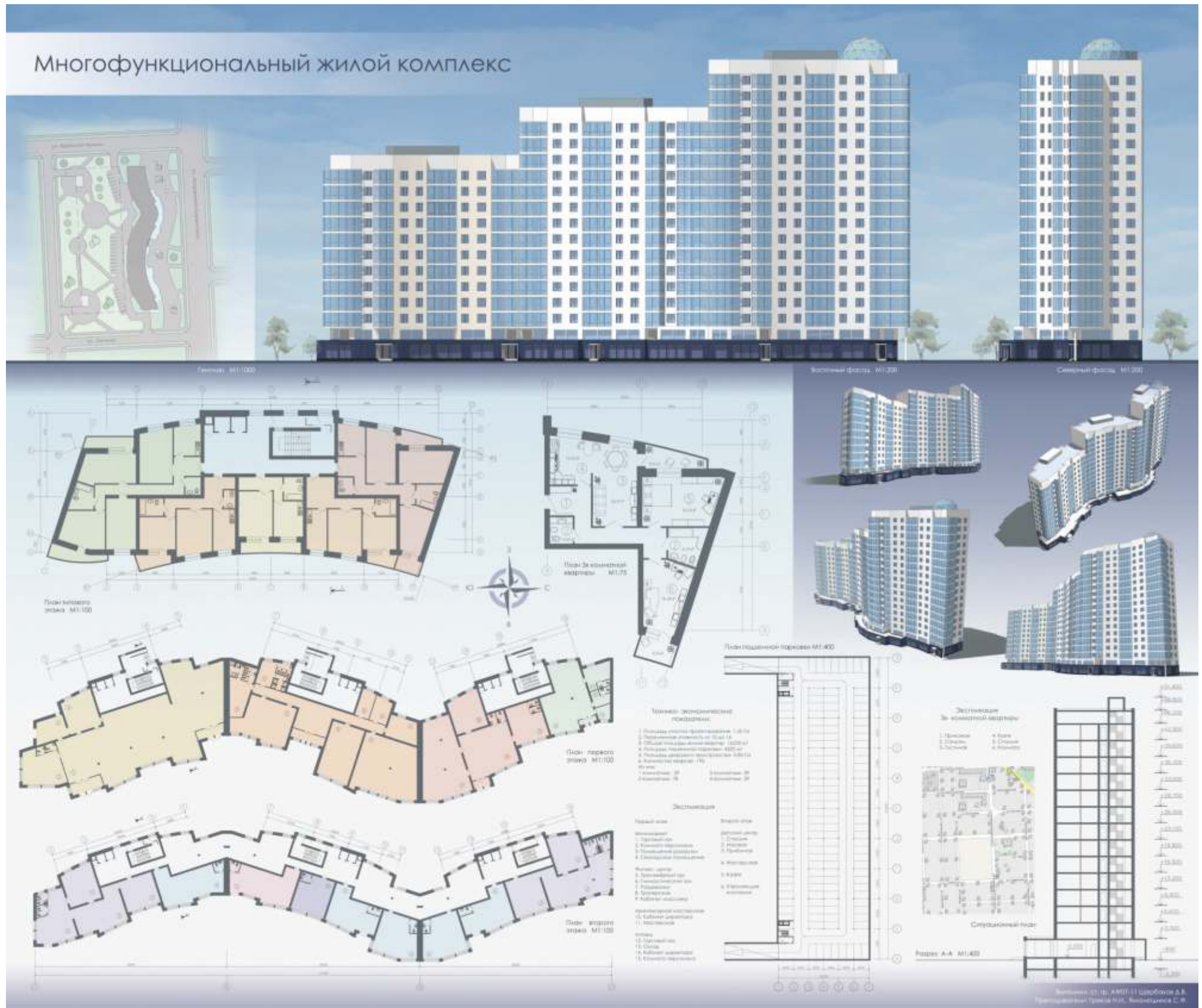

Multifunctional residential complex

Teachers:
Yamaletdinov S
Grekov N

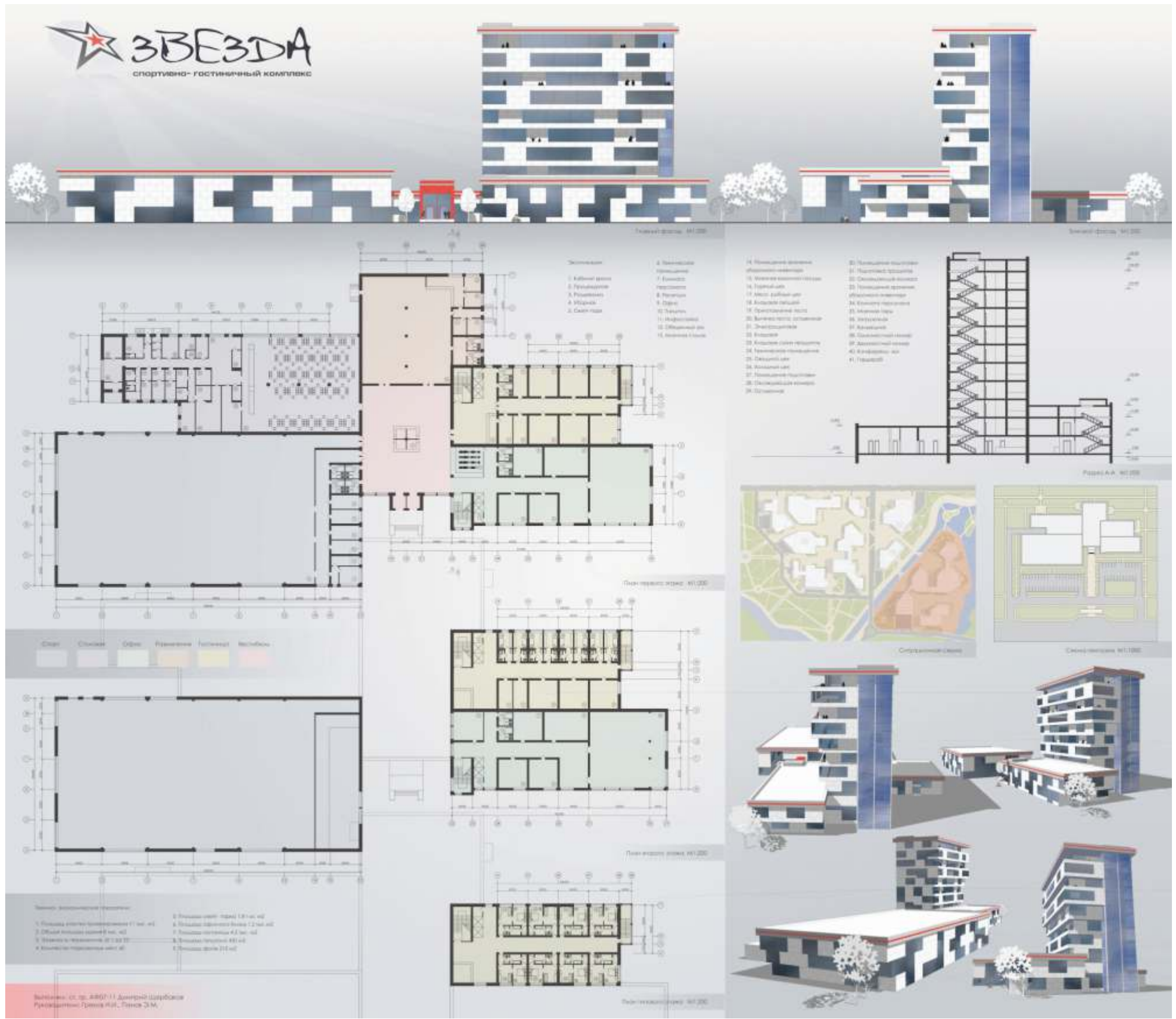

"Sport- hotel"

Teachers:
Panov E
Grekov N

Дизайн интерьера квартиры



План квартиры М 1 : 50



Развёртка М 1 : 50

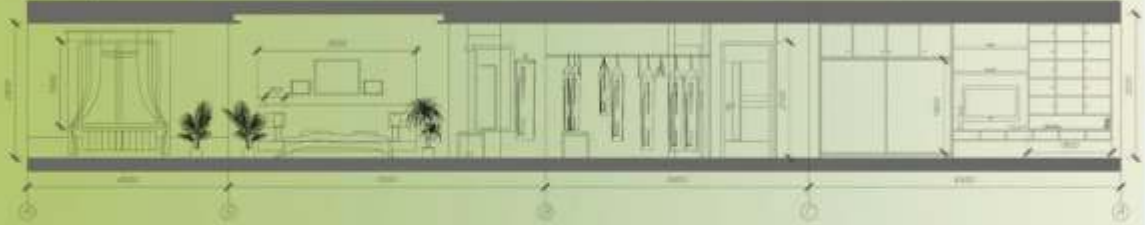

План потолка М 1 : 75

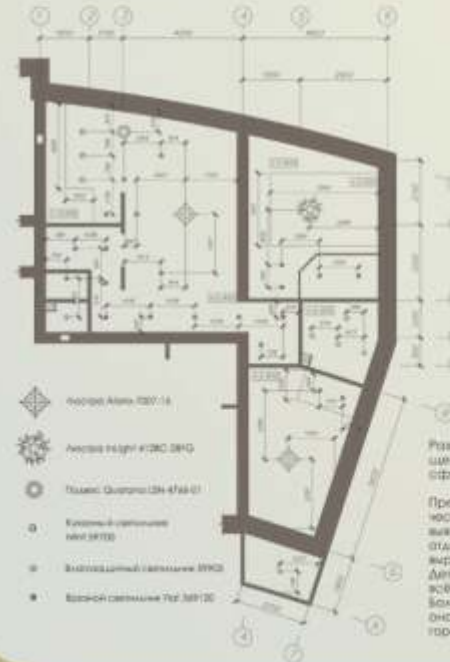

Опорный план М 1 : 75



"Interior design apartments"

Teachers:
Panov E
Grekov N



100 "City of 100 thousand inhabitants"

Teachers: Matnina T Dyadechkin N



100 "City of 100 thousand inhabitants"

Teachers: Matnina T Dyadechkin N

Реконструкция квартала в историческом центре города Красноярск



Reconstruction. Part 1

Teachers:
Kiselev T
Blinnikov B

Реконструкция квартала в историческом центре города Красноярск
Общественно-деловой центр



Reconstruction. Part 2

Teachers:
Kiselev T
Blinnikov B



_____ 297*297

_____ Dotum

_____ 300 / 2

_____ 1 .

_____ 660041, ,

_____ - , 82

E-mail _____ info@sfu-kras.ru

_____ www.sfu-kras.ru

_____ -

_____ "

Subject _____ PORTFOLIO

Designer _____ D. Shcherbakov

The editor _____ Kulikova M

Format _____ 297*297

Typeface _____ Dotum

Paper _____ 300 g/m2

Print _____ Inkjet

Circulation _____ 1 copy

Publisher _____ SFU IAaD

_____ 660041, Krasnojarsk,

_____ pr. Svobodnyy, 82

E-mail _____ info@sfu-kras.ru

_____ www.sfu-kras.ru

Printed _____ "Library and

_____ publishing

_____ complex SFU"

